

# Pull-Only T-Flex Controls

## Pull-Only T-Flex

Cost-effective product range for pull only applications. The inner cable is multi-strand, high-tensile steel and is tinned or galvanized for corrosion resistance. The outer is a flexible conduit comprised of one or two high-tensile steel wires, wound spirally to give maximum compression strength.

**Common Applications:** Clutch cable, throttle cable, hand brake cable, engine stop cable

- Protective covering of polypropylene, PVC, or can be uncoated
- Some sizes can be fitted with high density polypropylene liner for extra smooth low-friction operation
- Can fit a variety of accessory components, available in both UNF and metric thread options
- Wide range of sizes combinations w/loads range of 0 – 2200 lbs.
- Armored strands and solid wires available

**Material:**

- Plated steel (stainless steel optional)
- Pull-only twin-V high compression load conduit, lined and unlined

**Suggested End Fittings:**

- Clevises
- Eye ends

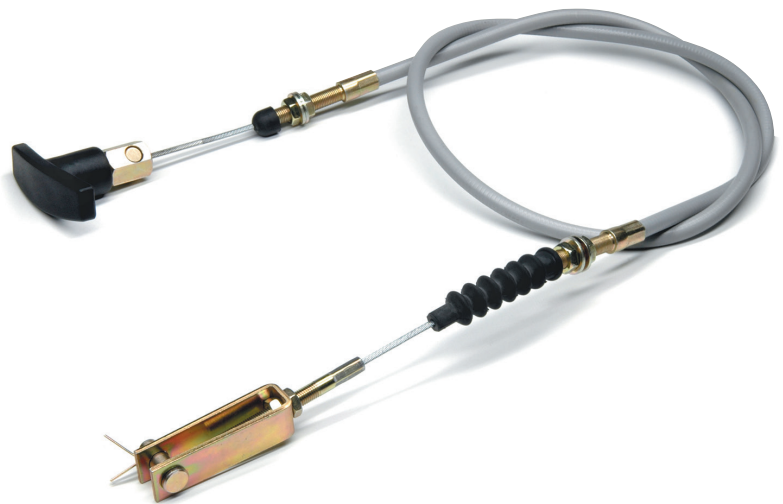

**Cablecraft**<sup>®</sup>  
Motion Controls



**Connecting a World  
in Motion**

# Pull-Only T-Flex Controls

## Pull-Only T-Flex Specifications

HB .375 Headed Bush

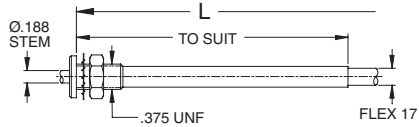

RB Reverse Bush (Die Cast)

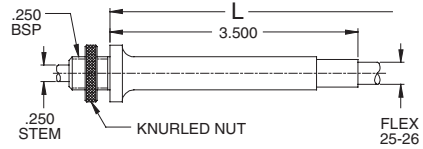

SP Sleeve Plain

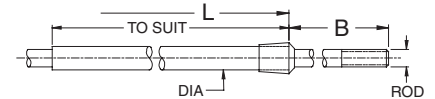

HB .500 Headed Bush

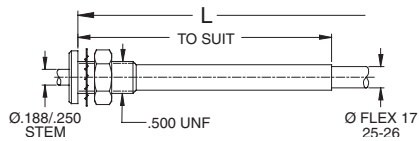

D Dashboard

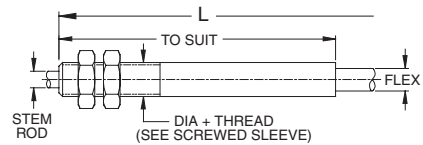

SS Sleeve Screwed

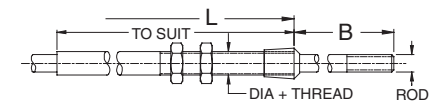

EP End Plain

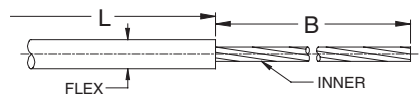

EC End Capped

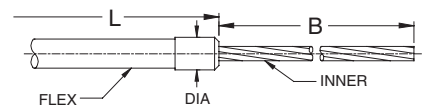

Knobs (Motif, Tee, Plain)

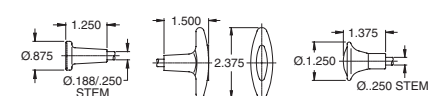

Distributed by:

**Cablecraft**<sup>®</sup>  
Motion Controls

2110 Summit Street  
New Haven, Indiana USA 46774  
Tel 260 749-5105 Fax 260 749-5677

4401 South Orchard Street  
Tacoma, Washington USA 98466  
Tel 253 475-1080 Fax 253 474-1623

**www.cablecraft.com**

2789 Old Belleville Road  
St. Matthews, South Carolina USA 29135  
Tel 803 655-7300 Fax 803 874-3558

Diplocks Way-South Road  
Hailsham, E. Sussex BN27 3JF, England  
Tel (011-44) 1323-841510 Fax (011-44) 1323-845848

**Warning:** Since the manufacturer is unable to determine all applications in which a part may be placed, it is the user's responsibility to determine the suitability of the part for its intended use. This is especially true where safety is a factor. Incorrect application or installation may result in property damage, bodily injury, or death. For technical assistance, call 260-749-5105.