

# Push-Pull 4B

## Control Cable Assembly

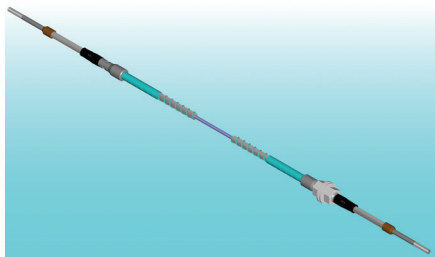

### Push-Pull Industrial

Commercial, cost effective product range for simple push-pull applications. Available in four different sizes. The inner member consists of a multi-strand high tensile steel cable, which is overwound with an armored covering to prevent spreading under compressive loads. This also gives a smooth surface for low-friction sliding action.

The conduit consists of low-friction hard plastic, reinforced by high tensile steel wires, of sufficient number and size to completely surround the plastic. The wires are laid longitudinally with a gradual spiral. Black UV stabilized polypropylene is extruded over the whole in a thickness sufficient to provide a tough hard-wearing jacket which will withstand working stressed between -40°C and 100°C. It is highly resistant to abrasion and most organic and inorganic media. Available with swivel flange, in both metric and UNF thread mounting fittings.



### Description:

Push-Pull 4B  
Industrial Control  
Cable Assembly

### Applications:

- Clutch controls
- Heavy duty lanyards

### Features:

- Truck crane — cross link system
- In conjunction with most control lever systems
- Power take off
- Gear selection
- Hydraulic valve systems
- Accelerator systems
- Stainless steel end rod options available

### Other Related Products:

- 4 sizes/duties available
- Swivel flange available (both metric and UNF threaded mounting fittings)
- Economically priced for cost effective solutions
- Black UV stabilized polypropylene
- Will withstand workings stressed between -40°C — 100°C

# Push-Pull 4B Specifications

## Push-Pull 4B30 — M5

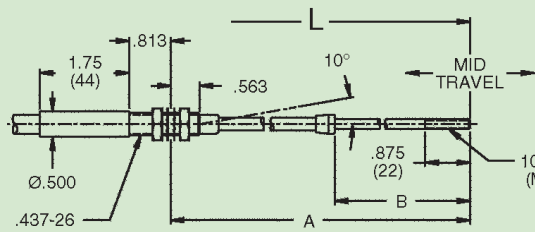

**B Bulkhead (Threaded)**

Travel	1"	25	2"	50	3"	75	4"	100
Dim "A"	4.375"	110	5.875"	150	7.375"	187	8.875"	225
Dim "B"	1.5"	38	2"	50	2.5"	63	3"	76

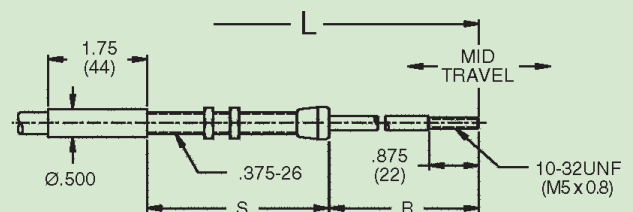

**D Dashboard (Rigid Ends)**

Travel	1"	25	2"	50	3"	75	4"	100
Dim "S"	3.25"	82	3.25"	82	4.5"	114	4.5"	114
"B" Min	1.5"	38	2"	50	2.5"	63	3"	76

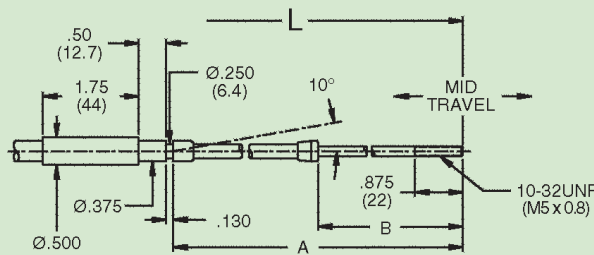

**C Clamp (Grooved)**

Travel	1"	25	2"	50	3"	75	4"	100
Dim "A"	3.785"	98	5.375"	136	6.875"	175	8.375"	213
Dim "B"	1.5"	38	2"	50	2.5"	63	3"	76

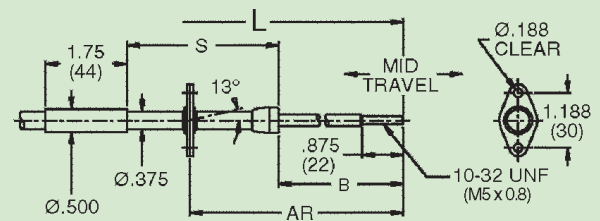

**SF Swivel Flange**

Travel	1"	25	2"	50	3"	75	4"	100
"S" Min	1.75"	44	2.75"	70	3.75"	95	4.75"	120
"B" Min	1.5"	38	2"	50	2.5"	63	3"	76

## Push-Pull 4B60 — M10

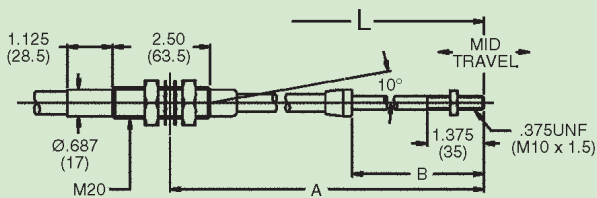

**B Bulkhead (Threaded)**

Travel	2"	50	3"	75	4"	100	5"	125
Dim "A"	7.375"	187	8.875"	225	10.375"	264	11.875"	302
Dim "B"	2.625"	67	3.125"	80	3.625"	92	4.125"	105

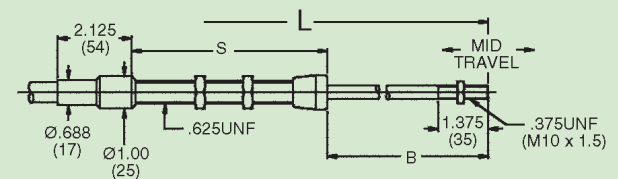

**D Dashboard (Rigid Ends)**

**AF Adj Flange**

Travel	1"	25	2"	50	3"	75	4"	100
Dim "S"	3.25"	82	3.25"	82	4.5"	114	5.5"	140
"B" Min	2.125"	54	2.625"	67	3.125"	79	3.625"	92

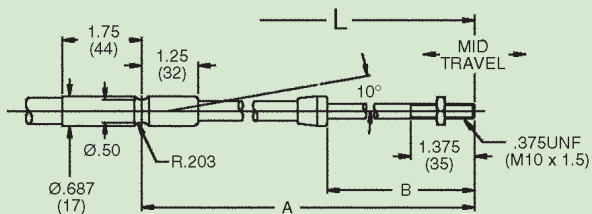

**C Clamp (Grooved)**

Travel	2"	50	3"	75	4"	100	5"	125
Dim "A"	6.125"	156	7.625"	194	9.125"	232	11.875"	302
Dim "B"	2.625"	67	3.125"	79	3.625"	92	4.125"	105

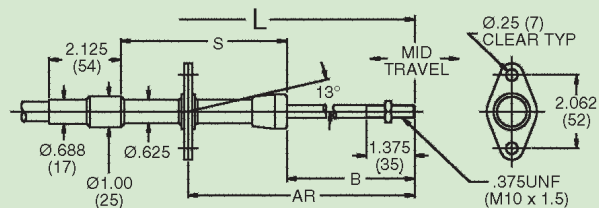

**SF Swivel Flange**

Travel	2"	50	3"	75	4"	100	5"	125
"S" Min	3.25"	82	4.5"	114	5.5"	140	6"	150
"B" Min	2.625"	67	3.125"	80	3.625"	92	4.125"	105

All line art dimensions are represented as follows: in (mm)

Note: Threads available in both UNF and metric

## Push-Pull 4B45 — M8

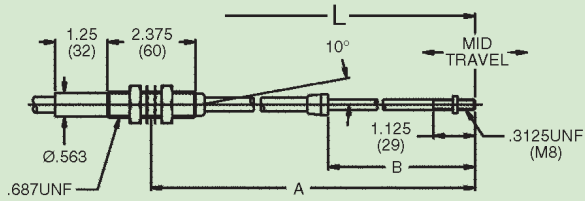

**B Bulkhead (Threaded)**

Travel	2"	50	3"	75	4"	100	5"	125
Dim "A"	6.625"	168	8.125"	206	9.625"	244	11.125"	283
Dim "B"	2.375"	60	2.875"	73	3.375"	86	3.875"	98

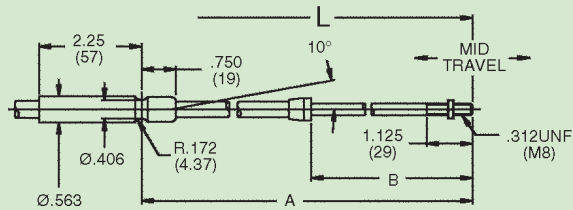

**C Clamp (Grooved)**

Travel	2"	50	3"	75	4"	100	5"	125
Dim "A"	5.875"	149	7.325"	187	8.875"	225	10.375"	270
Dim "B"	2.375"	60	2.875"	73	3.375"	86	3.875"	98

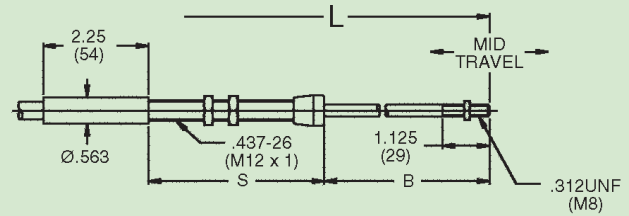

**D Dashboard (Rigid Ends)**

**AB Adj. Block**

**AF Adj. Flange**

Travel	1"	25	2"	50	3"	75	4"	100
Dim "S"	3.25"	82	3.25"	82	4.5"	114	4.5"	114
"B" Min	1.75"	44	2.25"	57	2.75"	70	3.25"	82

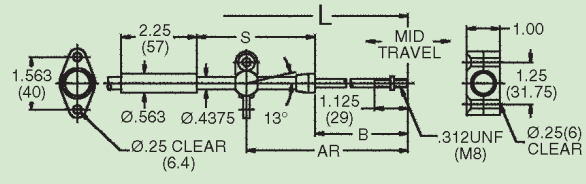

**SF Swivel Flange**

**SB Swivel Block**

Travel	2"	50	3"	75	4"	100	5"	125
"S" Min	2.75"	70	4"	101	4.75"	120	5.75"	146
"B" Min	2.25"	57	2.75"	70	3.25"	82	3.75"	95

## Push-Pull 4B45 — M6

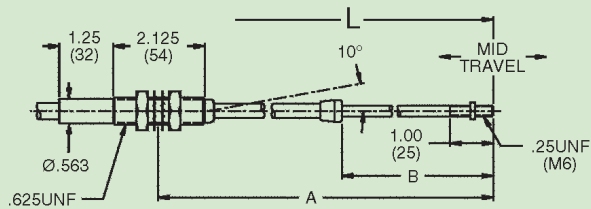

**B Bulkhead (Threaded)**

Travel	1"	25	2"	50	3"	75	4"	100
Dim "A"	4.625"	117	6.125"	55	7.625"	193	9.125"	232
Dim "B"	1.625"	41	2.125"	54	2.625"	67	3.125"	79

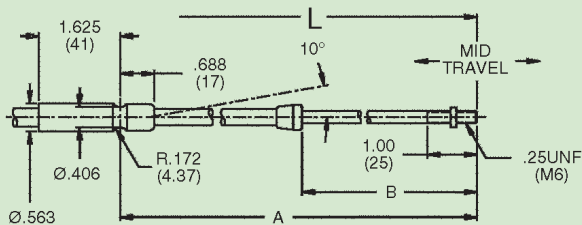

**C Clamp (Grooved)**

Travel	1"	25	2"	50	3"	75	4"	100
Dim "A"	4.625"	103	5.625"	141	7.125"	179	8.625"	217
Dim "B"	1.562"	40	2.125"	52	2.625"	65	3.125"	78

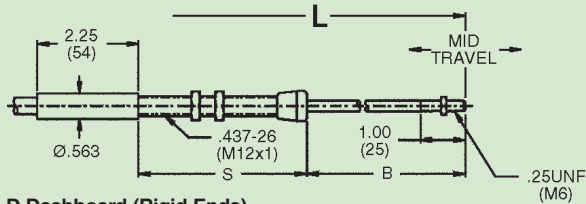

**D Dashboard (Rigid Ends)**

**AB Adj. Block**

**AF Adj. Flange**

Travel	1"	25	2"	50	3"	75	4"	100
Dim "S"	3.125"	82	3.25"	82	4.5"	114	4.5"	114
"B" Min	1.625"	41	2.125"	54	2.625"	68	3.125"	79

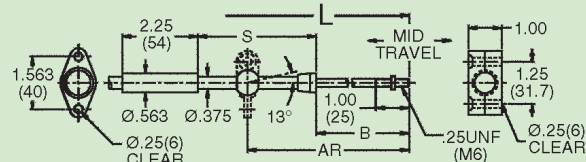

**SF Swivel Flange**

**SB Swivel Block**

Travel	1"	25	2"	50	3"	75	4"	100
"S" Min	1.75"	44	2.75"	70	3.75"	95	4.75"	120
"B" Min	1.625"	41	2.125"	54	2.625"	68	3.125"	79

All line art dimensions are represented as follows: in (mm)

Note: Threads available in both UNF and metric

# Push-Pull 4B Order Code

## Material

- Plated Steel  
Standard, Optional  
Stainless Steel
- Plastic Coated  
High Tensile Steel  
Lined Conduit
- Armored Push-  
Pull Steel  
Innermember
  - Black  
polypropylene

## Suggested End Fittings

- Rod Ends

## Cablecraft® Ordering Codes — UNF Threads

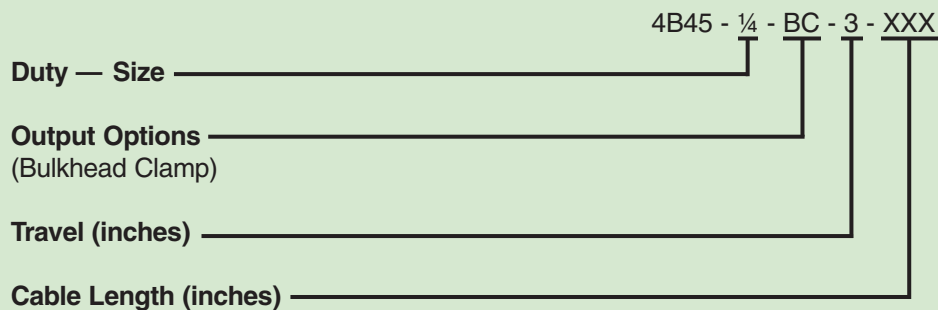

## Cablecraft® Ordering Codes — Metric Threads

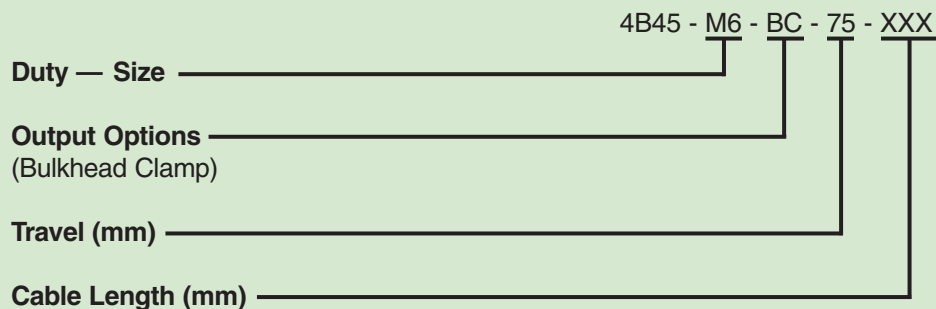

Linking Motion  
& Control...  
The Cablecraft  
Solution

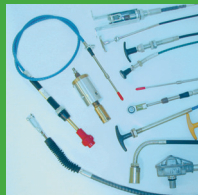

## WARNING!

*Since the manufacturer is unable to determine all applications in which a part may be placed, it is the user's responsibility to determine the suitability of the part for its intended use. This is especially true where safety is a factor. Incorrect application or installation may result in property damage, bodily injury, or death. For technical assistance, call 260-749-5105.*

**Cablecraft®**  
Cablecraft Motion Controls

2110 Summit Street  
New Haven, Indiana USA 46774  
Tel 260 749-5105 Fax 260 749-5677  
4401 South Orchard Street  
Tacoma, Washington 98411 USA  
Tel 253 475-1080 Fax 253 474-1623

Diplocks Way-South Road  
Hailsham, East Sussex BN27 3JF, England  
Tel 44 1323 841510 Fax 44 1323 845848

[www.cablecraft.com](http://www.cablecraft.com)